

ASSEMBLY INSTRUCTIONS:

Product Code : GSC9422

Product Name: Rapidline Shelving Unit



TIME REQUIRED:

30 minutes

TOOLS REQUIRED:

Screwdriver, Electric Drill, Pencil, Measuring tape/Ruler

*Tools are not included.

SKILL REQUIRED:

Easy  Hard

The Assembly Skill Rating is a 5-point system that shows the degree of effort needed in assembling a specific product. With 1 being easy for the average person and 5 requiring an expert. For most products, two persons are recommended.

NOTE

- As this is a commercial product, some intermediate skills may be required.
- No pre-drill holes or markings are provided on our table or desk tops.
- Please check you have all hardware before assembling.
- If you are missing any hardware, please contact the Apex team. Please ensure you have the name of the item, required hardware part and quantity.
- Please retain your receipt as proof of purchase to validate your warranty.
- Assemble on a clean, flat, smooth surface such as a rug or carpet to avoid parts from being scratched.
- Remove all wrapping materials, including staples and packing straps before you start to assemble
- Keep all hardware parts out of reach of children.

CAUTION

- Heavy product. Do not attempt to lift or move without help
- Do not tighten screws and bolts until completely assembled.
- Do not use this product unless all bolts and screws are firmly secured and tightened.

WARNING

- If parts are missing, broken, damaged or worn stop using the product until all repairs are made.
- Failure to follow these warnings could result in serious injury.

Assembly Instructions : GSC9422

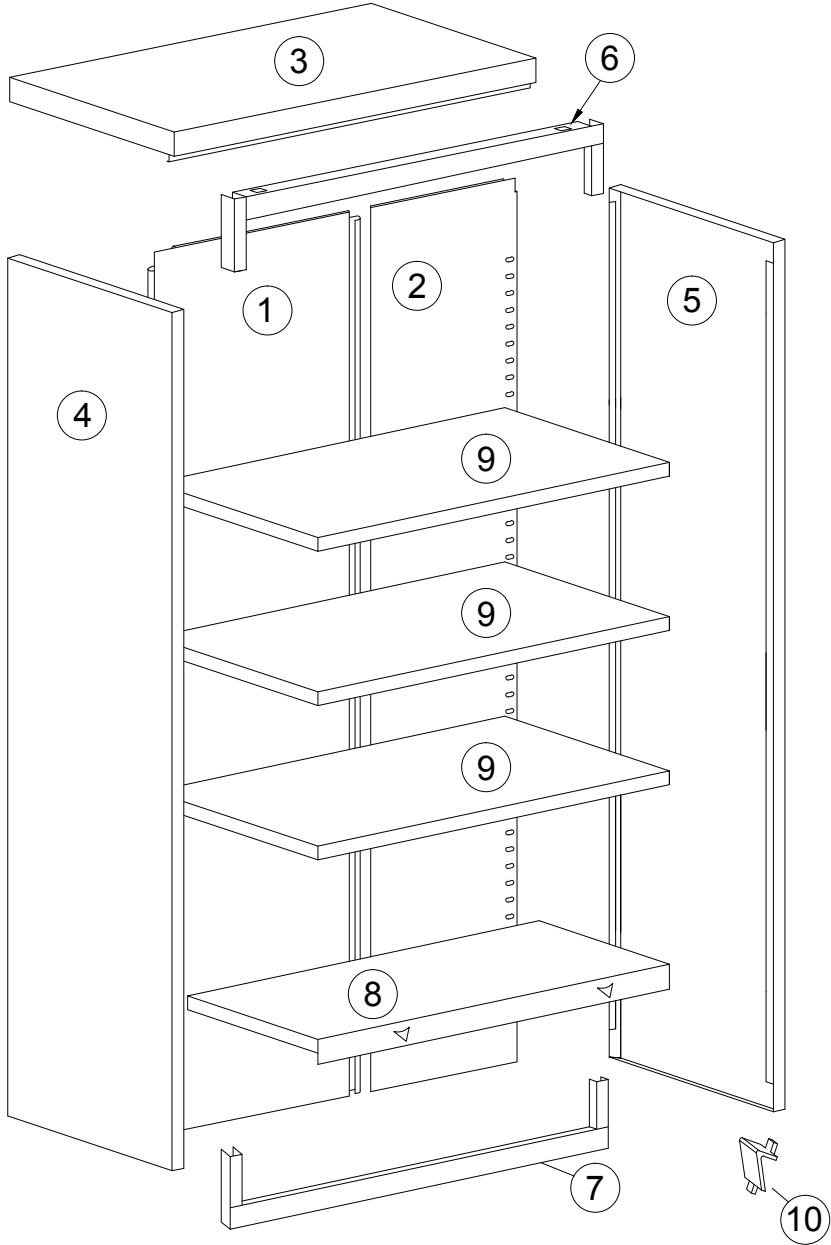

PART LIST

| No. | COMPONENT | QUANTITY |
|-----|----------------|----------|
| 01 | LH BACK | 01 |
| 02 | RH BACK | 01 |
| 03 | TOP | 01 |
| 04 | LH SIDE | 01 |
| 05 | RH SIDE | 01 |
| 06 | 'U' FRAME | 01 |
| 07 | KICK PLATE | 01 |
| 08 | BOTTOM | 01 |
| 09 | SHELF | 05 |
| 10 | SHELF SUPPORTS | 20 |

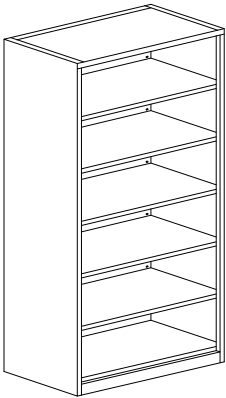

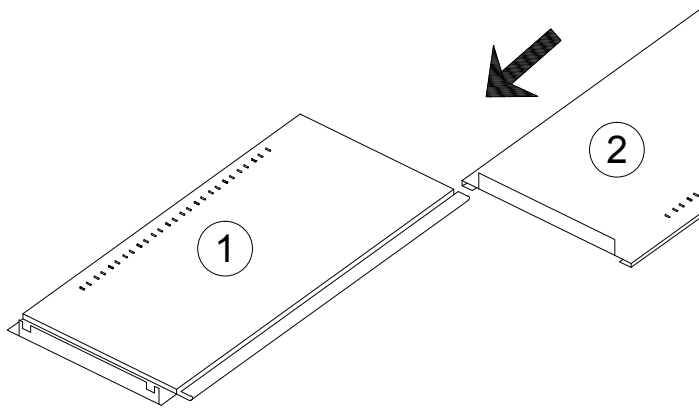

STEP-1

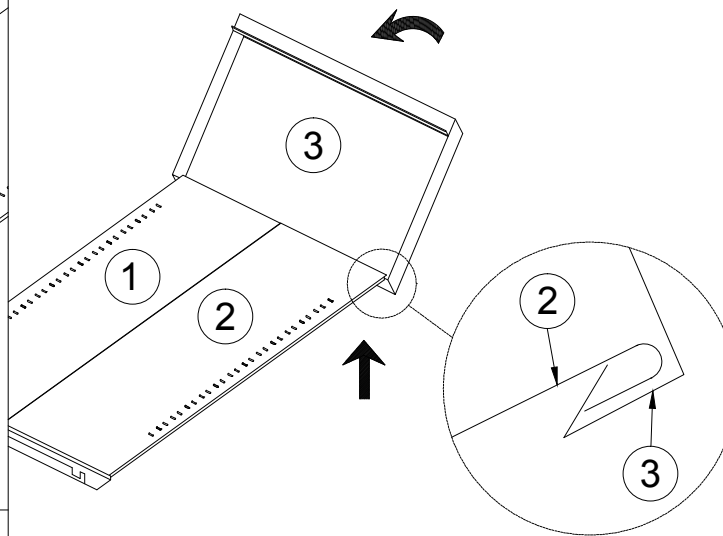

STEP-2

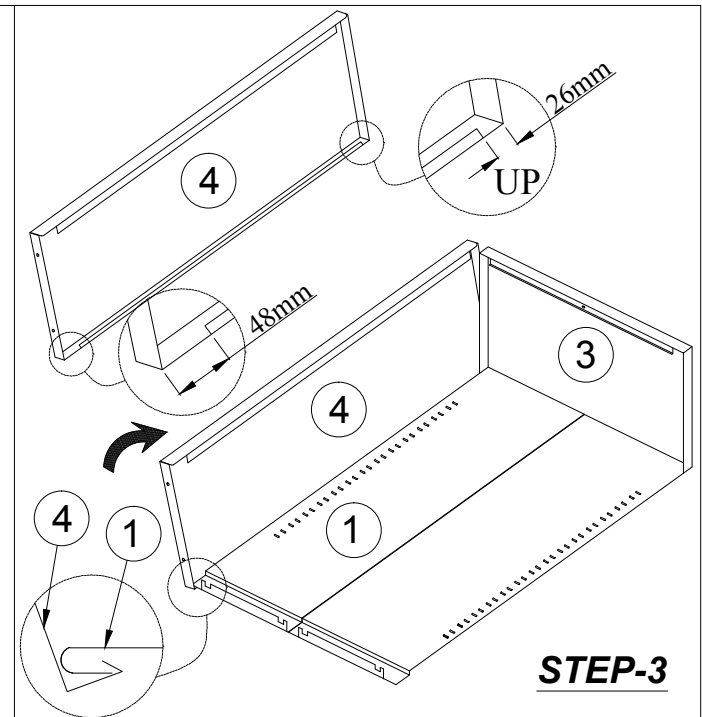

STEP-3

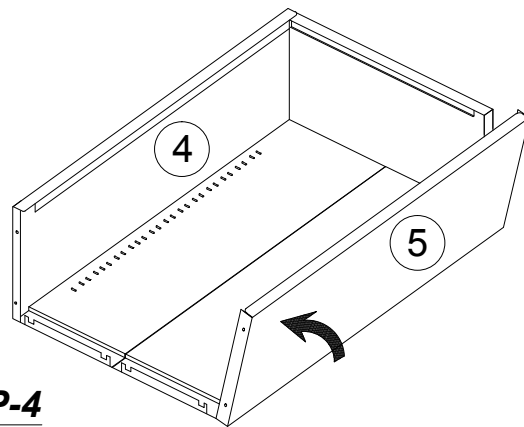

STEP-4

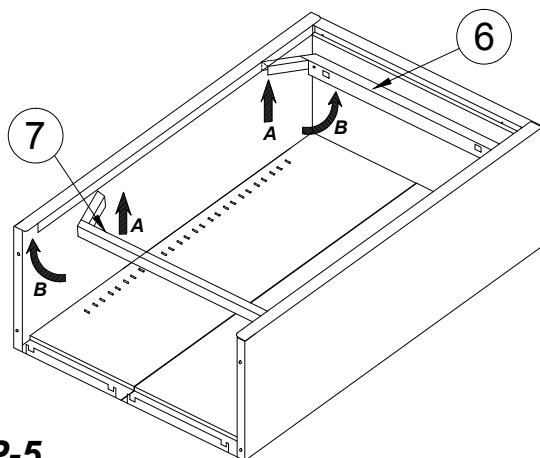

STEP-5

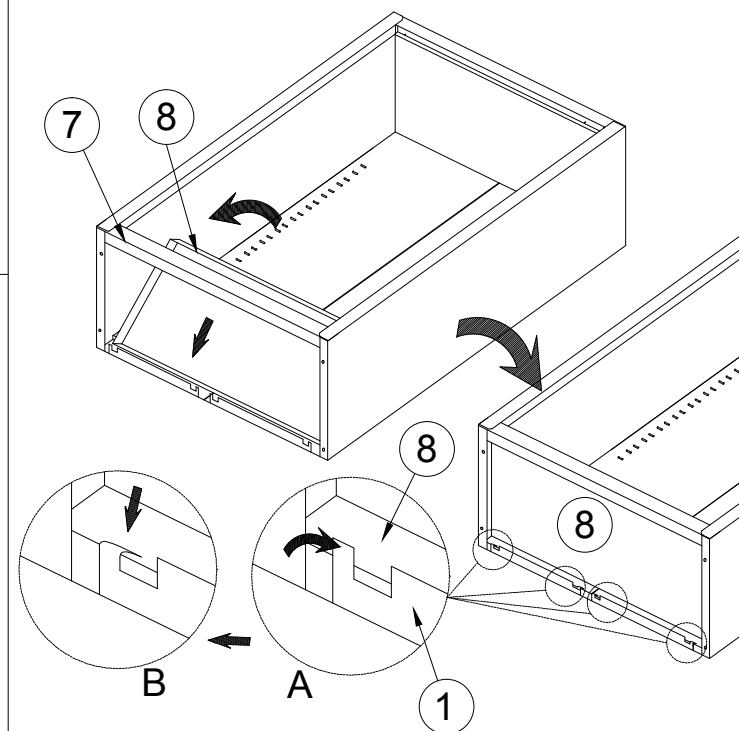

STEP-6

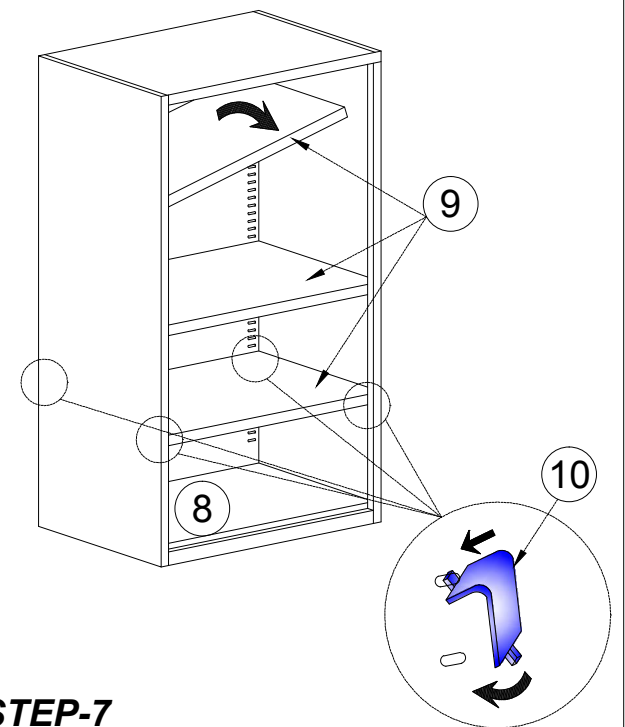

STEP-7